

Name: Ricardo Monteiro	Date: 2010-02-14	Event: Novamodel Challenge
City: Portugal	State: _____	
Track: Vizela		

Track Conditions	<input type="checkbox"/> Indoor	<input type="checkbox"/> Tight	<input type="checkbox"/> Smooth	<input type="checkbox"/> Hard Packed	<input checked="" type="checkbox"/> Blue Groove	<input type="checkbox"/> Wet	<input type="checkbox"/> Low Bite	<input type="checkbox"/> High Bite
	<input checked="" type="checkbox"/> Outdoor	<input checked="" type="checkbox"/> Open	<input checked="" type="checkbox"/> Rough	<input checked="" type="checkbox"/> Loose/Loamy	<input type="checkbox"/> Dry	<input type="checkbox"/> Dusty	<input checked="" type="checkbox"/> Med Bite	<input type="checkbox"/> Other _____

Front Suspension

Toe: - 1°

Ride Height: 28 mm.

Camber: - 0,5°

Caster: 12° Optional

Sway Bar: 2,5 mm.

Piston/Oil: 54 / 45 wt.

Spring: Silver

Limiter/Droop: 95 mm.

Overall Shock Length: 95 mm.

Steering Ackerman: Long

Bump Steer: Up

Camber Link: 2 / B

Shock Location: 1 / Inside

Receiver Battery Type: Losi LiPo

Differentials

Front: Standard Smart

Spring Wire Dia: _____

Qty of Springs: _____

Ramp Plate: _____

Grease: _____

Diff Fluid: 4.000 cps

Center: Standard Smart

Spring Wire Dia: _____

Qty of Springs: _____

Ramp Plate: _____

Grease: _____

Diff Fluid: 6.000 cps

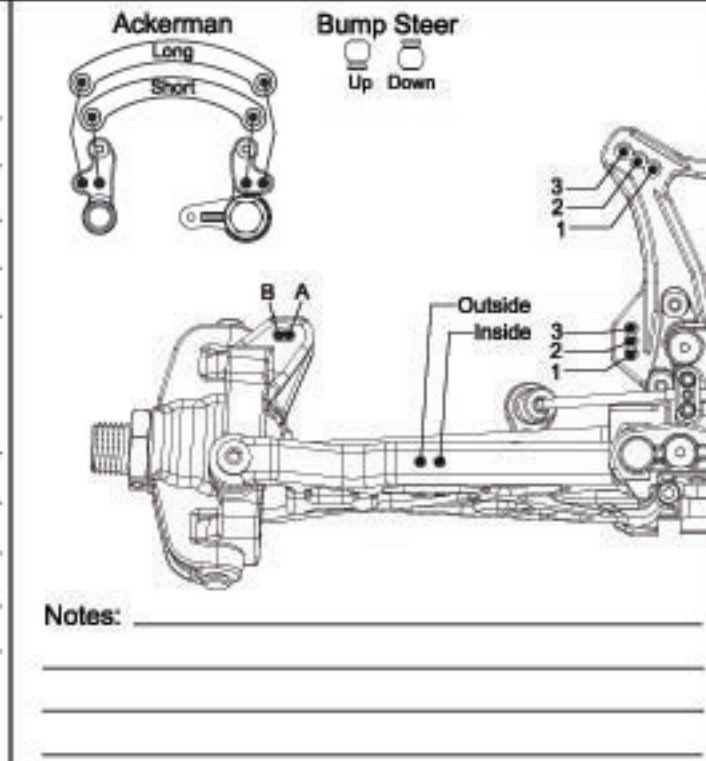

Rear Suspension

Toe: + 3°

Anti-Squat: 3°

Ride Height: 29 mm.

Camber: - 2,5°

Rear Hub Spacing: Middle

Sway Bar: 2,7 mm.

Piston/Oil: 56 / 25 wt.

Spring: Green

Limiter/Droop: 105 mm.

Overall Shock Length: 105 mm.

Camber Link: 2 / B

Shock Location: 1 / Inside

Rear Diff Fluid: 3.000 cps

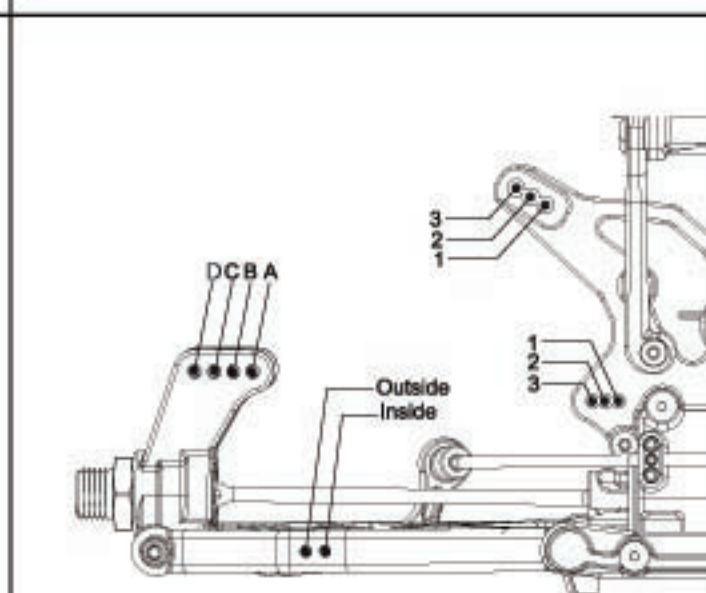

Engine

Engine: RB B9 Fuel: RB Fuel

Glow Plug: RB #6 Turbo Head Clearance: .30

Pipe/Header: RB 2045 c/192 Gearing: _____

Clutch

Clutch Shoes and Springs Info

4 x Aluminium Shoes

2 x Black Springs

2 x Green Springs

Tires

	Type	Compound	Insert
Front:	<u>AKA Cross Brace</u>	<u>Soft</u>	<u>AKA original</u>
Rear:	<u>AKA Cross Brace</u>	<u>Soft</u>	<u>AKA original</u>

Notes: Very Fast and very consistent. TQ & Victory